

**SKIP\*HOP®**

187601.04

**ZOO®  
3-in-1 ride on**



**OWNER'S MANUAL**

Read all instructions and warnings before assembly and use of 3-in-1 ride-on.

**IMPORTANT! KEEP INSTRUCTIONS FOR FUTURE USE**

**CONTENTS:**

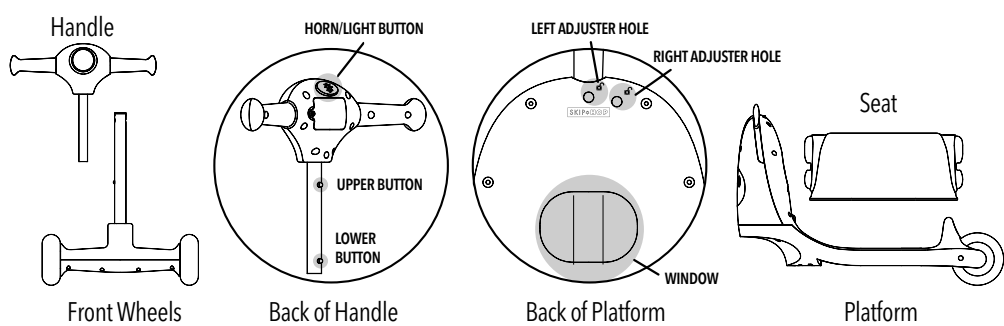

**CLEANING AND CARE:**

Spot clean only. Do not submerge in water.

**STAGE 1: WAGON MODE**

Adult assembly required.

1. Insert front wheels with the "locator" in the FRONT. Check the window to make sure the metal button is visible on the RIGHT side.

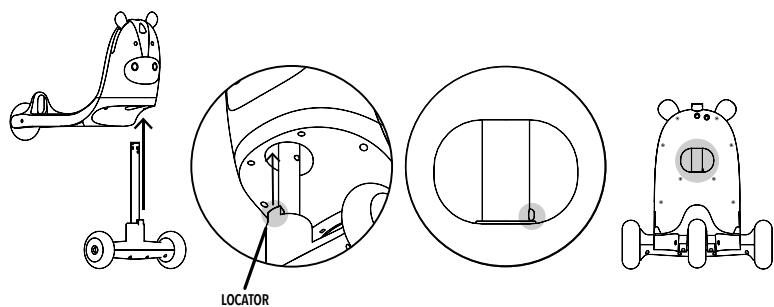

2A. Insert handle with the Horn/Light Button facing FRONT. Press in lower button while pushing handle down until it clicks.

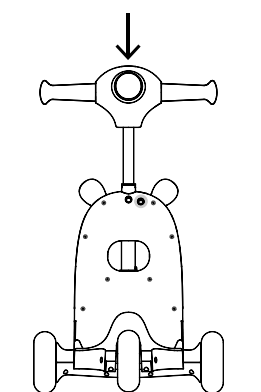

2B. Press screwdriver into RIGHT adjuster hole and push down handle until it won't go any further.

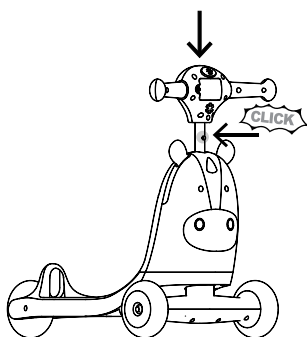

2C. Press in upper button while pushing handle down until it clicks.

3. Flip seat upside down and press side buttons to assemble seat to base.

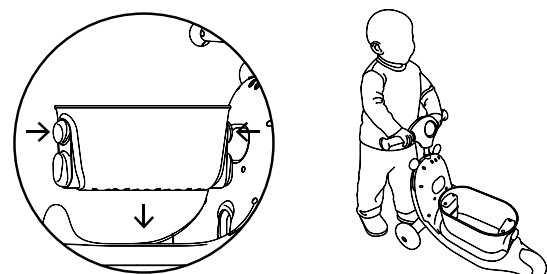

**BATTERY INFORMATION**

At the end of product life, remove batteries from product by following the battery replacement instructions. Always dispose of used batteries properly. See section on safety and disposal information. • Batteries are to be inserted with the correct polarity. • Do not burn batteries. • Non-rechargeable batteries are not to be recharged. • Rechargeable batteries are only to be charged under adult supervision. • Rechargeable batteries are to be removed from the toy before being charged. • Exhausted batteries are to be removed from the toy. • The supply terminals are not to be short-circuited. • Different types of batteries or new and used batteries are not to be mixed. • Do not mix alkaline, standard (carbon-zinc), or rechargeable batteries.

**STAGE 2: RIDE ON MODE**

Adult assembly required.

1. Remove handle by pressing screwdriver into RIGHT adjuster hole while pulling the handle all the way out.

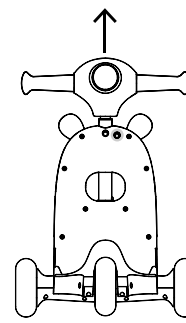

2. Remove front wheels by pressing metal button in the window and pulling the wheels all the way out.

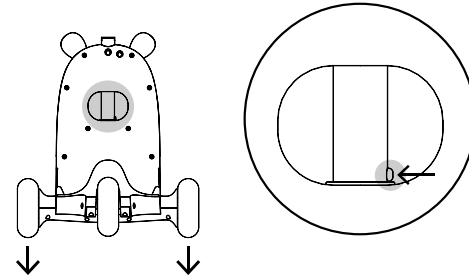

3. Re-insert front wheels with the "locator" in the BACK. Check the window to make sure the metal button is visible on the LEFT side.

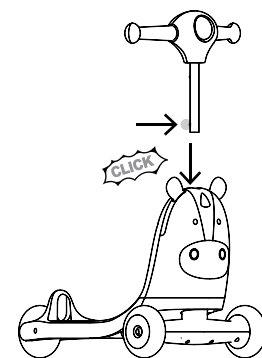
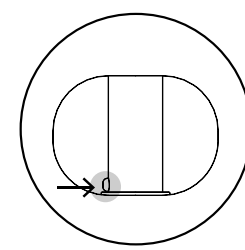
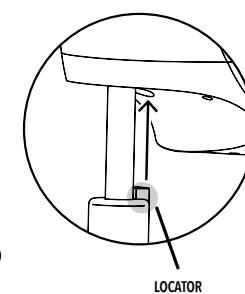
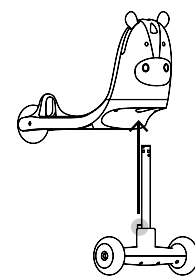

4A. Insert handle with the Horn/Light Button facing the BACK. Press in lower button while pushing handle down until it clicks.

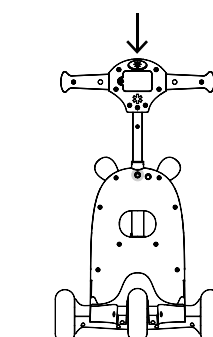

4B. Press screwdriver into LEFT adjuster hole and push down handle until it won't go any further.

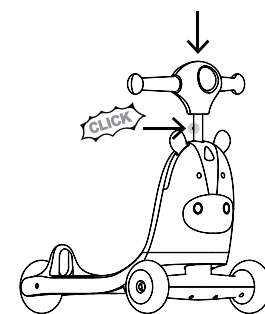

4C. Press in upper button while pushing handle down until it clicks.

5. Remove seat, flip over, and re-attach to base while pressing in buttons.

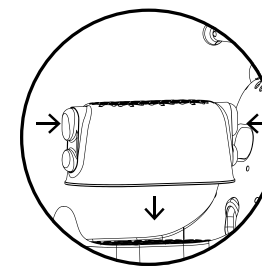

**ASSEMBLY: SCOOTER MODE**

Adult assembly required.

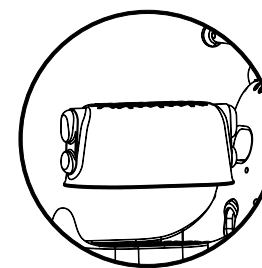

1. Remove seat while pressing release buttons.

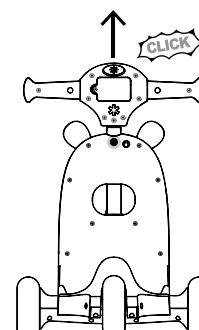

2. Raise handle by pressing screwdriver into LEFT adjuster hole and pulling to release the upper button. Release the screwdriver and pull until the lower button clicks into place.



**TO REPLACE BATTERIES:**

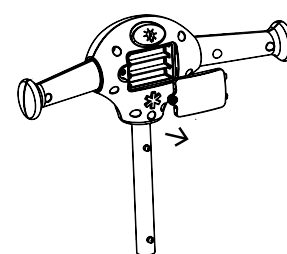

1. Loosen the battery door screw using a Philips head screwdriver.

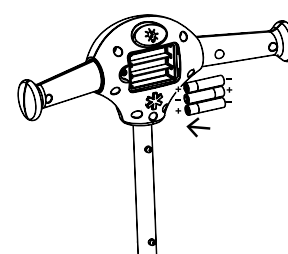

2. Open battery door compartment and insert three new AAA (1.5V) Alkaline batteries. Be sure to insert with correct polarity.

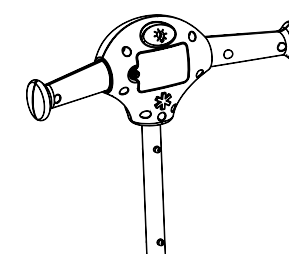

3. Position the battery door securely back into place and tighten with a screwdriver. \*Batteries should be replaced by an adult.

**WARNING**

Adult assembly required. To reduce the risk of injury, adult supervision is required. The toy should be used with caution as skill is required in order to avoid falls or collisions, causing injury to the user or third parties. Never use in roadways, near motor vehicles, on or near steep inclines or steps, swimming pools or other bodies of water; always wear shoes, and never allow more than 1 rider. Not for children with a body weight of 44lb (20kg) or more. This toy has no brake. Protective equipment should be worn such as a helmet, gloves, knee-pads and elbow-pads. Not to be used in traffic or public highways. Only use the battery(ies) specified by the manufacturer.

© Skip Hop, Inc.  
100 W 33 ST, STE 1125  
NY, NY 10001  
In the US: 888.782.9548  
www.skiphop.com

Meets or exceeds ASTM F963 and applicable safety standards.

